

Plotted: 9/25/2019 5:49 PM by Rogers, Sarah File Name: p:\2017\2017\_6224\10\_17\_6224.dwg

© Copyright 2018. All rights reserved. No part of this document may be reproduced in any form or by any means without permission from Wiss, Janney, Elstner Associates, Inc. (WJE). WJE disclaims any responsibility for its unauthorized use.

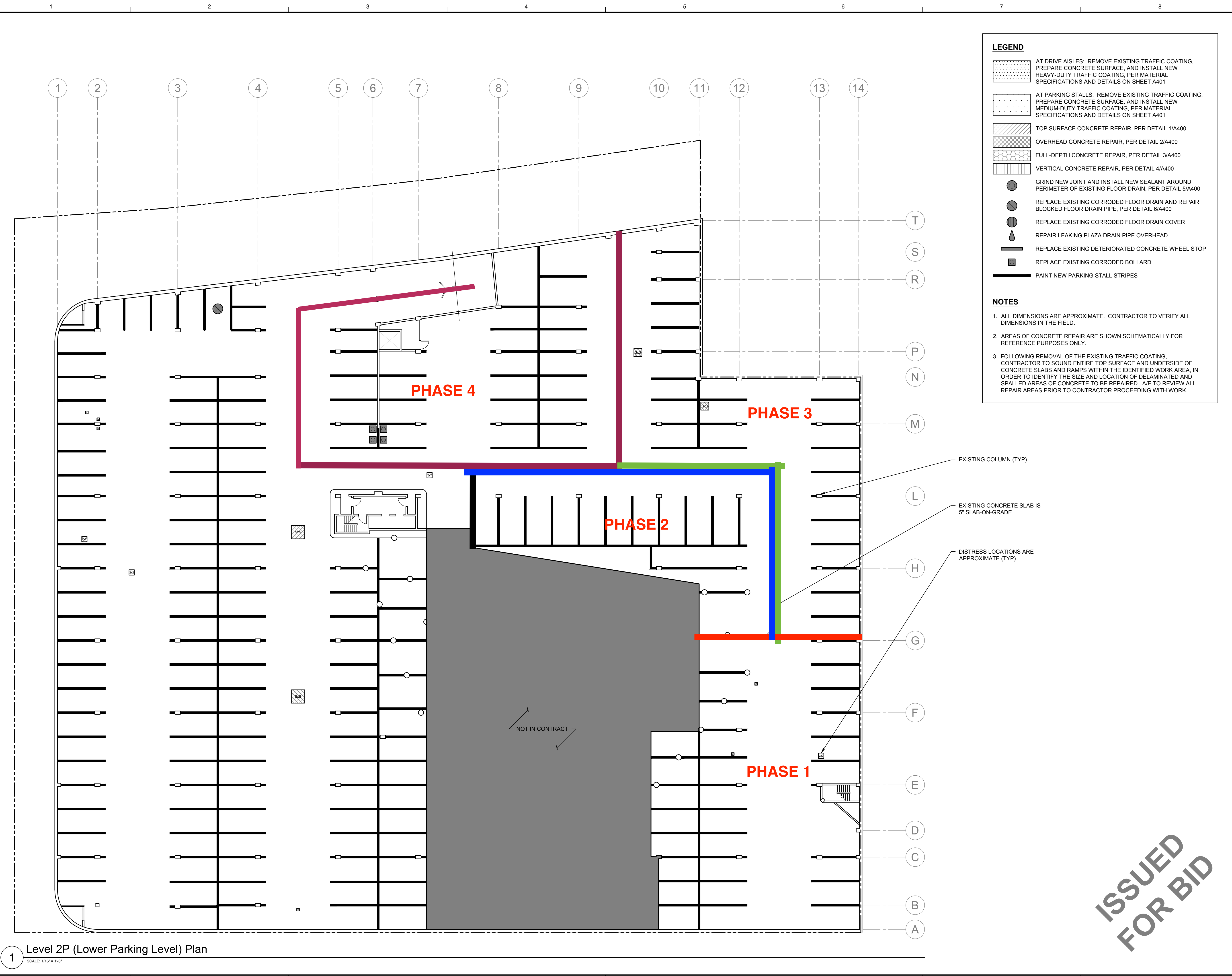

**LEGEND**

- AT DRIVE AISLES: REMOVE EXISTING TRAFFIC COATING, PREPARE CONCRETE SURFACE, AND INSTALL NEW HEAVY-DUTY TRAFFIC COATING, PER MATERIAL SPECIFICATIONS AND DETAILS ON SHEET A401
- AT PARKING STALLS: REMOVE EXISTING TRAFFIC COATING, PREPARE CONCRETE SURFACE, AND INSTALL NEW MEDIUM-DUTY TRAFFIC COATING, PER MATERIAL SPECIFICATIONS AND DETAILS ON SHEET A401
- TOP SURFACE CONCRETE REPAIR, PER DETAIL 1/A400
- OVERHEAD CONCRETE REPAIR, PER DETAIL 2/A400
- FULL-DEPTH CONCRETE REPAIR, PER DETAIL 3/A400
- VERTICAL CONCRETE REPAIR, PER DETAIL 4/A400
- GRIND NEW JOINT AND INSTALL NEW SEALANT AROUND PERIMETER OF EXISTING FLOOR DRAIN, PER DETAIL 5/A400
- REPLACE EXISTING CORRODED FLOOR DRAIN AND REPAIR BLOCKED FLOOR DRAIN PIPE, PER DETAIL 6/A400
- REPLACE EXISTING CORRODED FLOOR DRAIN COVER
- REPAIR LEAKING PLAZA DRAIN PIPE OVERHEAD
- REPLACE EXISTING DETERIORATED CONCRETE WHEEL STOP
- REPLACE EXISTING CORRODED BOLLARD
- PAINT NEW PARKING STALL STRIPES

**NOTES**

1. ALL DIMENSIONS ARE APPROXIMATE. CONTRACTOR TO VERIFY ALL DIMENSIONS IN THE FIELD.
2. AREAS OF CONCRETE REPAIR ARE SHOWN SCHEMATICALLY FOR REFERENCE PURPOSES ONLY.
3. FOLLOWING REMOVAL OF THE EXISTING TRAFFIC COATING, CONTRACTOR TO SOUND ENTIRE TOP SURFACE AND UNDERSIDE OF CONCRETE SLABS AND RAMPS WITHIN THE IDENTIFIED WORK AREA, IN ORDER TO IDENTIFY THE SIZE AND LOCATION OF DELAMINATED AND SPALLED AREAS OF CONCRETE TO BE REPAIRED. A/E TO REVIEW ALL REPAIR AREAS PRIOR TO CONTRACTOR PROCEEDING WITH WORK.

**WJE** ENGINEERS ARCHITECTS MATERIALS SCIENTISTS

**Wiss, Janney, Elstner Associates, Inc.**  
 10 South LaSalle Street, Suite 2600  
 Chicago, Illinois 60603  
 312.372.0555 tel | 312.372.0873 fax  
 www.wje.com

Headquarters & Laboratories: Northbrook, Illinois  
 Atlanta | Austin | Boston | Chicago | Cleveland | Dallas | Denver | Detroit  
 Honolulu | Houston | Los Angeles | Minneapolis | New Haven | New York  
 Philadelphia | Princeton | San Francisco | Seattle | South Florida | Washington, D.C.

Consultants

Project

**Park Tower - Parking Garage Repair Project**  
 5415 North Sheridan Road  
 Chicago, Illinois 60640

Client

**Park Tower Condo Association**  
 5415 North Sheridan Road,  
 Suite 107  
 Chicago, Illinois 60640

2019-09-25 Issued for Bid

Mark	Date	Description

0 1/2" 1" 2"  
 THIS SHEET PLOTS FULL SIZE AT 24x36 (INCHES)

Project No.	2017.6224
Date	2019-09-25
Drawn	SLR
Checked	GIT
Scale	As Noted

**Level 2P Plan**

Sheet Title

Sheet No. **A100**

ISSUED FOR BID

1 Level 2P (Lower Parking Level) Plan  
 SCALE: 1/16" = 1'-0"

Plotted: 9/25/2019 5:49 PM by Rogers, Sarah File Name: p:\2017\2017\_6224\17\_6224.0 - park tower condos - garage assessment (gjit)\Drawings\Sheets\A101 - Level 1P Plan.dwg

© Copyright 2018. All rights reserved. No part of this document may be reproduced in any form or by any means without permission from Wiss, Janney, Elstner Associates, Inc. (WJE). WJE disclaims any responsibility for its unauthorized use.

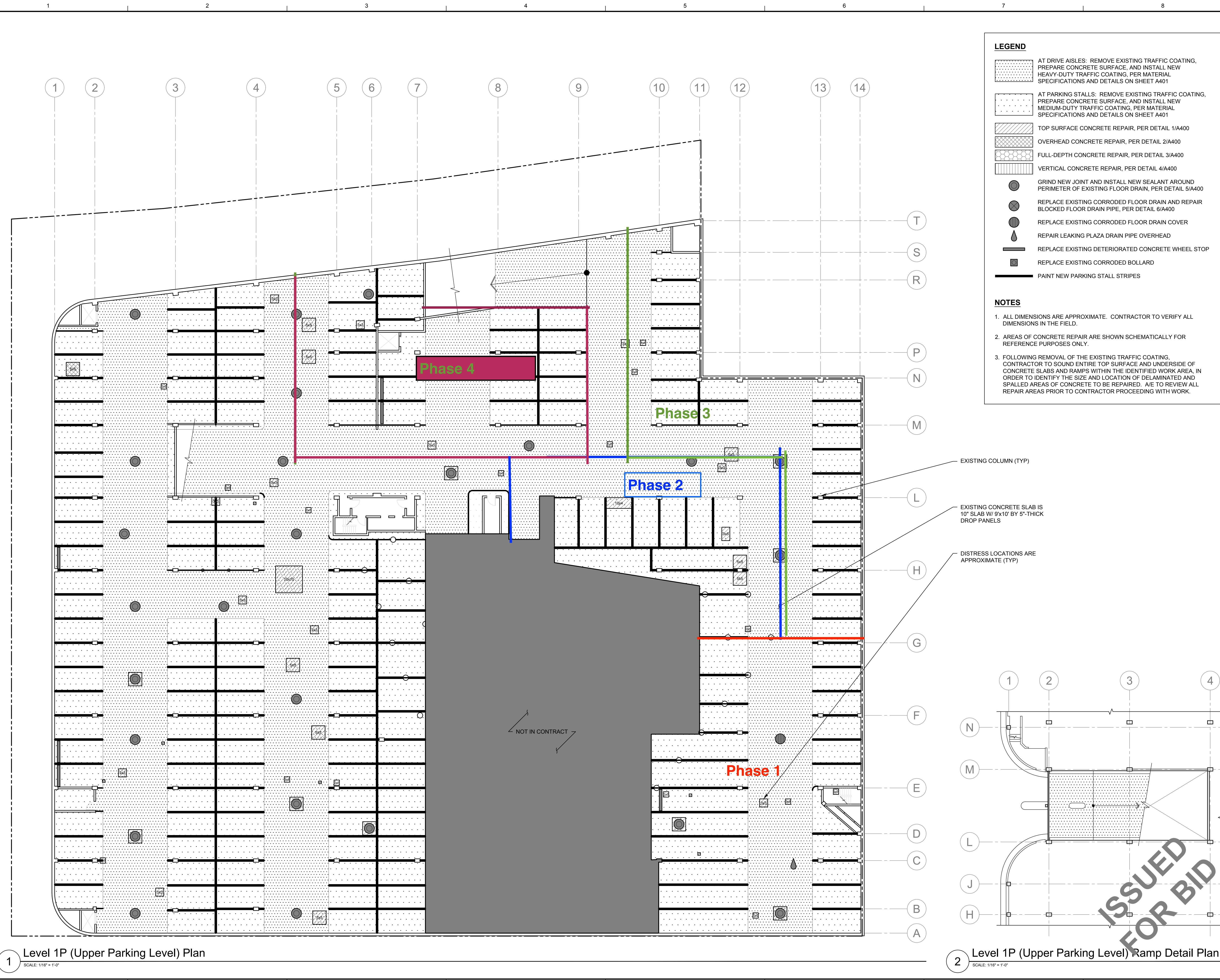

**LEGEND**

- AT DRIVE AISLES: REMOVE EXISTING TRAFFIC COATING, PREPARE CONCRETE SURFACE, AND INSTALL NEW HEAVY-DUTY TRAFFIC COATING, PER MATERIAL SPECIFICATIONS AND DETAILS ON SHEET A401
- AT PARKING STALLS: REMOVE EXISTING TRAFFIC COATING, PREPARE CONCRETE SURFACE, AND INSTALL NEW MEDIUM-DUTY TRAFFIC COATING, PER MATERIAL SPECIFICATIONS AND DETAILS ON SHEET A401
- TOP SURFACE CONCRETE REPAIR, PER DETAIL 1/A400
- OVERHEAD CONCRETE REPAIR, PER DETAIL 2/A400
- FULL-DEPTH CONCRETE REPAIR, PER DETAIL 3/A400
- VERTICAL CONCRETE REPAIR, PER DETAIL 4/A400
- GRIND NEW JOINT AND INSTALL NEW SEALANT AROUND PERIMETER OF EXISTING FLOOR DRAIN, PER DETAIL 5/A400
- REPLACE EXISTING CORRODED FLOOR DRAIN AND REPAIR BLOCKED FLOOR DRAIN PIPE, PER DETAIL 6/A400
- REPLACE EXISTING CORRODED FLOOR DRAIN COVER
- REPAIR LEAKING PLAZA DRAIN PIPE OVERHEAD
- REPLACE EXISTING DETERIORATED CONCRETE WHEEL STOP
- REPLACE EXISTING CORRODED BOLLARD
- PAINT NEW PARKING STALL STRIPES

**NOTES**

1. ALL DIMENSIONS ARE APPROXIMATE. CONTRACTOR TO VERIFY ALL DIMENSIONS IN THE FIELD.
2. AREAS OF CONCRETE REPAIR ARE SHOWN SCHEMATICALLY FOR REFERENCE PURPOSES ONLY.
3. FOLLOWING REMOVAL OF THE EXISTING TRAFFIC COATING, CONTRACTOR TO SOUND ENTIRE TOP SURFACE AND UNDERSIDE OF CONCRETE SLABS AND RAMPS WITHIN THE IDENTIFIED WORK AREA, IN ORDER TO IDENTIFY THE SIZE AND LOCATION OF DELAMINATED AND SPALLED AREAS OF CONCRETE TO BE REPAIRED. A/E TO REVIEW ALL REPAIR AREAS PRIOR TO CONTRACTOR PROCEEDING WITH WORK.

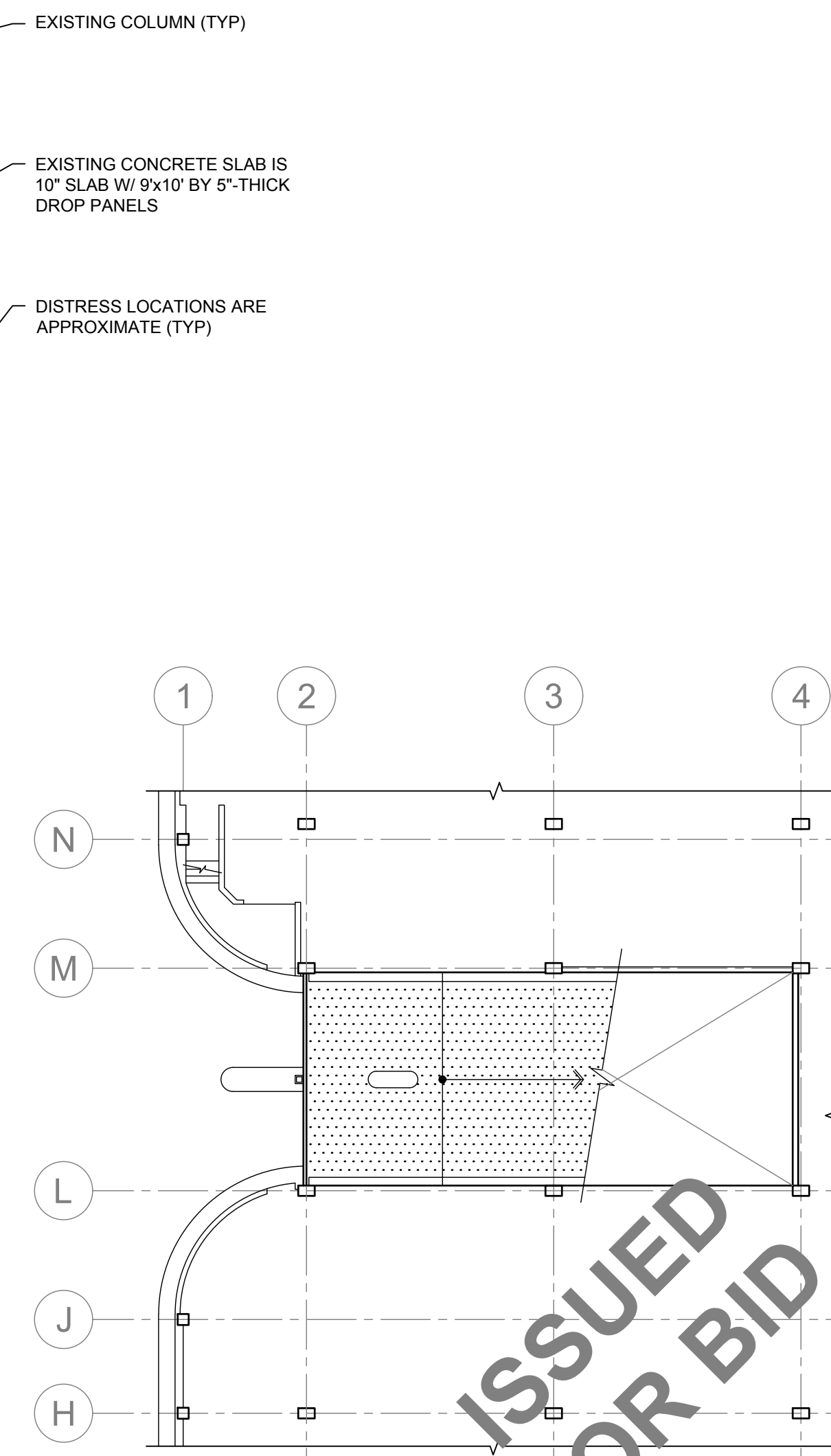

**WJE** ENGINEERS  
ARCHITECTS  
MATERIALS SCIENTISTS

**Wiss, Janney, Elstner Associates, Inc.**  
10 South LaSalle Street, Suite 2600  
Chicago, Illinois 60603  
312.372.0555 tel | 312.372.0873 fax  
www.wje.com

Headquarters & Laboratories: Northbrook, Illinois  
Atlanta | Austin | Boston | Chicago | Cleveland | Dallas | Denver | Detroit  
Honolulu | Houston | Los Angeles | Minneapolis | New Haven | New York  
Philadelphia | Princeton | San Francisco | Seattle | South Florida | Washington, D.C.

Consultants

Project

**Park Tower - Parking Garage  
Repair Project**  
5415 North Sheridan Road  
Chicago, Illinois 60640

Client

**Park Tower Condo Association**  
5415 North Sheridan Road,  
Suite 107  
Chicago, Illinois 60640

Mark	Date	Description
2019-09-23	2019-09-23	Issued for Bid
<p>THIS SHEET PLOTS FULL SIZE AT 24x36 (INCHES)</p>		
Project No.	2017.6224	
Date	2019-09-25	
Drawn	SLR	
Checked	GIT	
Scale	As Noted	
Sheet Title	Level 1P Plan	
Sheet No.	A101	

1 Level 1P (Upper Parking Level) Plan  
SCALE: 1/16" = 1'-0"

2 Level 1P (Upper Parking Level) Ramp Detail Plan  
SCALE: 1/16" = 1'-0"